

EAK OPEN TYPE

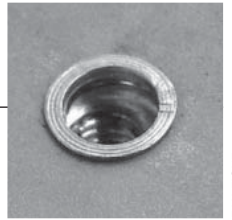

EAK-FICHE

For installation information please refer to the tooling overview and manuals on our website www.scell-it.com
 Pour les conditions de pose, merci de vous référer à la description de l'outil et aux manuels disponibles sur notre site web.
 Angaben zur Verarbeitung entnehmen Sie bitte der Geräteübersicht und den Betriebsanleitungen auf unserer Website.
 Pro informace ohledně montáže navštivte naše webové stránky nebo nahlédněte do manuálu k nářadí.

ENGLISH	FRANÇAIS	DEUTSCH	CZECH
Insert / Knurled	Ecrou / Cranté	Einnietmutter / Gerillt	nýtovací matice / s rýhovaným dřikem
Countersunk head	Tête fraisée à 90°	Senkkopf	zapuštěná hlava
Aluminium	Aluminium	Aluminium	hliník

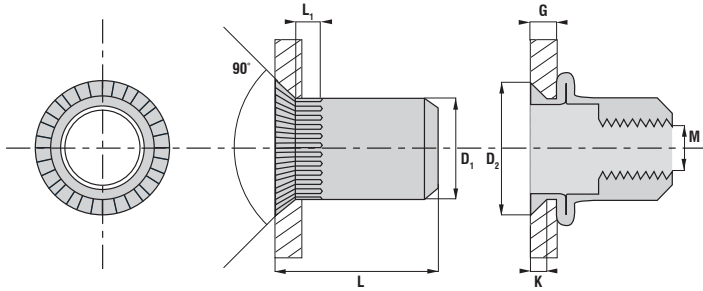

PART NO/REF	M	D ₁	D ₂	K	L	L ₁	G
	Ø (mm)	Ø (mm)	Ø (mm)	(mm)	(mm)	(mm)	min-max (mm)
EAK0435	M4	5.9	9.0	1.5	11.5	4.5	1.5-3.5
EAK0540	M5	6.9	10.0	1.5	13.5	5.0	1.5-4.0
EAK0640	M6	8.9	12.0	1.5	16.0	5.5	1.5-4.5
EAK0840	M8	10.9	14.0	1.5	19.0	5.5	1.5-4.5
EAK1040	M10	12.9	15.0	1.5	21.0	5.5	1.5-4.5

	DRILLING	RECOMMENDED MAX TORQUE	PULL-OUT	SHEAR
M (mm)	(mm)	(Nm)	(N)	(N)
M4	6.0	4.0	2 800	1 000
M5	7.0	5.0	4 900	1 100
M6	9.0	11.3	9 200	2 200
M8	11.0	14.5	14 000	2 400
M10	13.0	20.0	21 000	3 800

UNIT PLANT CERTIFICATES



Scell-it®
 Engineering & Development

© 2009 Blue future Intellectual Proterities

Data shown are subject to change without prior notice as a result of continuous product development and improvement policy.
 Your local Scell-it representative is at your disposal should you need to confirm latest information.